

# CASE STUDY

## Metal Hose – Tight Spot

---

**Challenge:** Customer needed a hose routed in a tight spot but couldn't find standard hose fittings that could meet their requirements. We were able to design a custom hose end that could be crimped without exceeding 100R1 bend radius and still mate with port adapters. The port locations changed though during initial design of the machine.

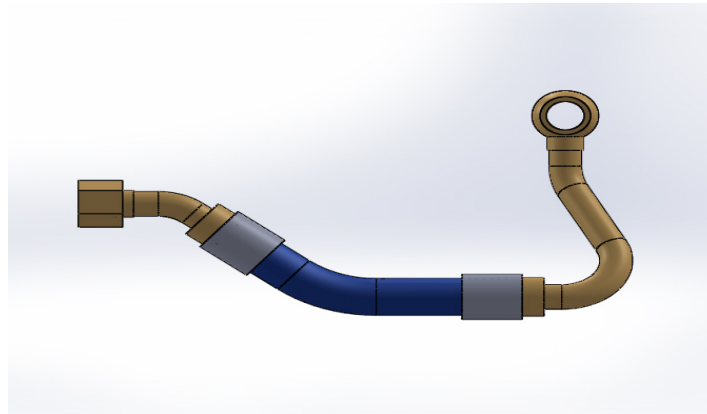

**Solution:** A custom metal hose assembly became the obvious choice. We still needed flexibility. Conventional crimping prevented the routing due to a larger minimum bend radius and stem length.

**Benefits:** Metal hose has higher working temperatures and can be welded closer to the tangent of the bend allowing for quicker and sharper bends in the assembly. Metal hose is also more compatible with certain corrosive fluids and tough in extreme environments.

